

BECKER CENTRONIC PLUS MOTOR, ADDING ADDITIONAL REMOTE TO AN EXISTING INSTALLATION FLOWCHART P1 BCPFC 007

PAGE 1 OF 2

SCAN HERE !



VIDEO INSTRUCTIONS

START: USE A CENTRONIC PLUS REMOTE ALREADY PROGRAMMED INTO THE CURRENT INSTALLTION

1 PRESS AND HOLD PROGRAM BUTTON (1) ON THE BACK OF THE CURRENTLY PROGRAMMED REMOTE FOR 3 SECONDS. THIS PROMPTS THE TRANSMITTER TO SEARCH FOR ALL MOTORS AND SENSORS IN THE SAME NETWORK. DURING SEARCH, LED RING WILL CONTINUALLY CHANGE COLOUR. THE CLOSEST MOTOR TO THE TRANSMITTER WILL MAKE 1 X JOG THEN LED RING WILL TURN EITHER GREEN OR BLUE (2)

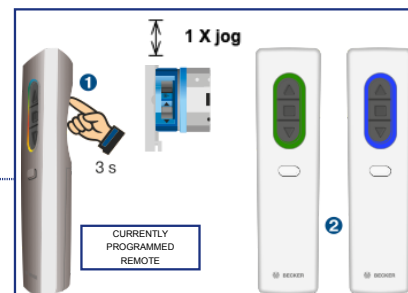

2 HOLD THE NEW REMOTE CLOSE TO THE CURRENTLY PROGRAMMED REMOTE. PRESS AND HOLD THE PROGRAM BUTTON ON THE BACK OF THE NEW REMOTE, UNTIL THE LED RINGS ON BOTH TRANSMITTERS FILL SLOWLY CLOCKWISE WITH GREEN LED SEGMENTS. RELEASE THE PROGRAM BUTTON WHEN LED RING LIGHT FILLS COMPLETELY GREEN THEN FLASHES TWICE AND GOES OUT.

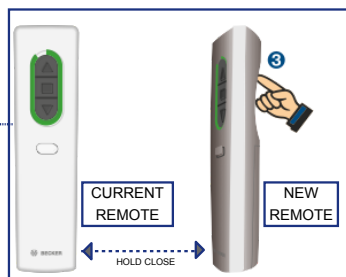

3 NEW REMOTE IS NOW ADDED TO THE INSTALLATION AND HAS JOINED THE MESH NETWORK. "REMOTE CHANNELS STILL NEED TO BE PROGRAMMED TO MOTORS"

4 ASSIGNED NEW REMOTE CHANNELS TO MOTORS PAGE 2

BECKER CENTRONIC PLUS MOTOR ASSIGNING CHANNELS TO MOTOR ON ADDITIONAL REMOTE FLOWCHART P2- BCPFC 007 PAGE 2

PAGE 2 OF 2

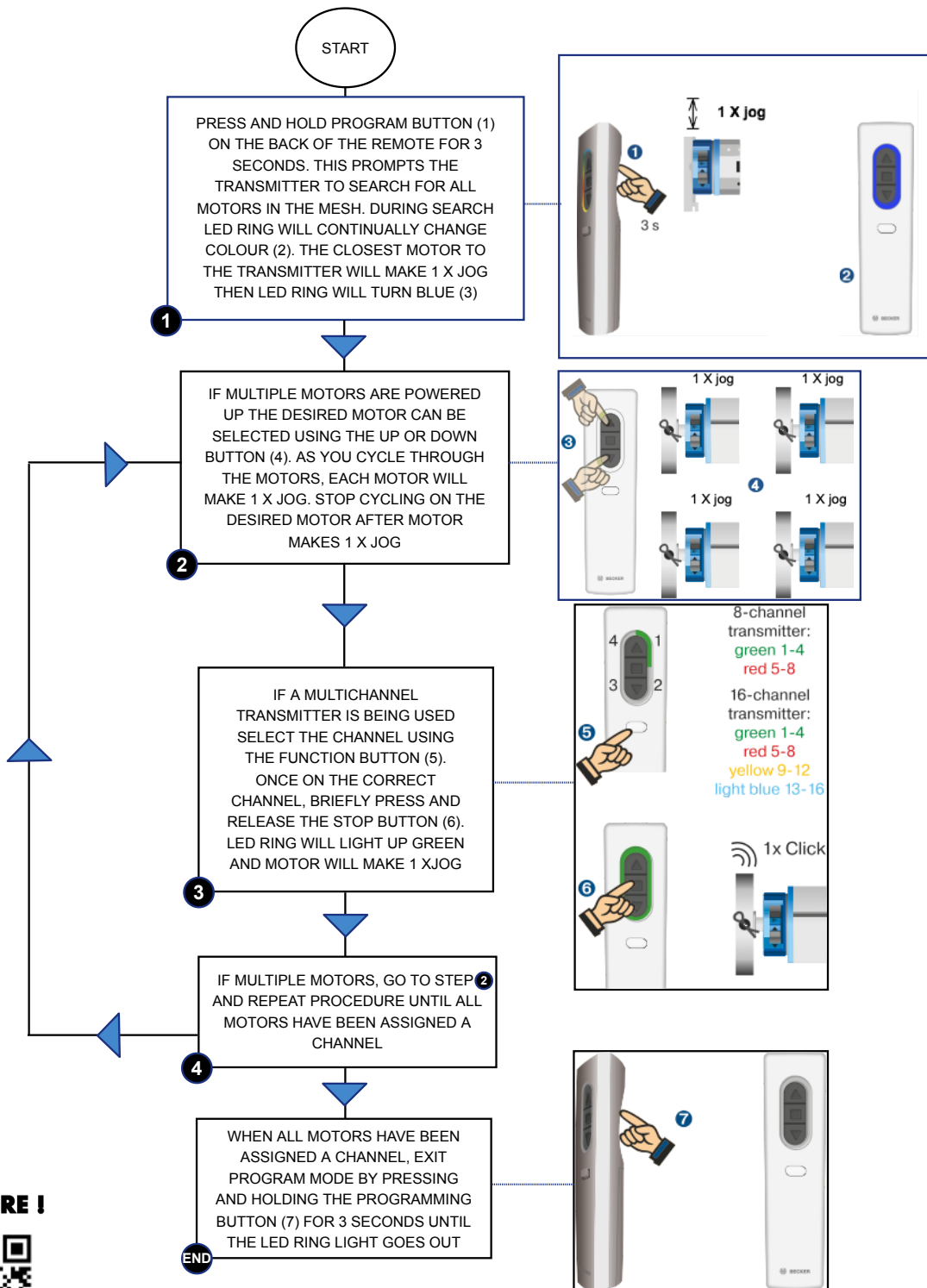

SCAN HERE !



VIDEO INSTRUCTIONS